

UNDIVIDED CARRIAGEWAY

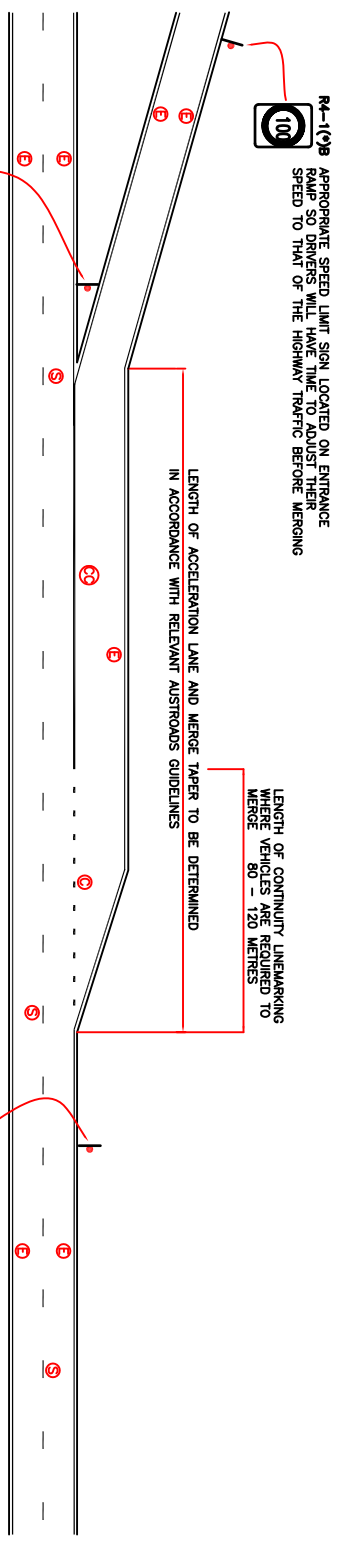

DIVIDED CARRIAGEWAY

PLACE IN THE MERGE GORE SO THAT SIGNS ARE VISIBLE TO BOTH TRAFFIC STREAMS

APPROPRIATE SPEED LIMIT SIGN TO BE LOCATED APPROXIMATELY 100 METRES AFTER THE RAMP TERMINAL

DRAFTING		DESIGN		DEPARTMENT OF INFRASTRUCTURE, ENERGY AND RESOURCES, TASMANIA			
NO.	AMENDMENTS	CHECKED	DATE	APPROVED	DATE	DESIGNED	DATE
1						D Thomas	16/9/04
2						P Hubbe	
3							
4							
5							
6							
7							
8							
9							
10							
11							
12							
13							
14							
15							
16							
17							
18							
19							
20							
21							
22							
23							
24							
25							
26							
27							
28							
29							
30							
31							
32							
33							
34							
35							
36							
37							
38							
39							
40							
41							
42							
43							
44							
45							
46							
47							
48							
49							
50							
51							
52							
53							
54							
55							
56							
57							
58							
59							
60							
61							
62							
63							
64							
65							
66							
67							
68							
69							
70							
71							
72							
73							
74							
75							
76							
77							
78							
79							
80							
81							
82							
83							
84							
85							
86							
87							
88							
89							
90							
91							
92							
93							
94							
95							
96							
97							
98							
99							
100							

ARRANGEMENT AT ON-RAMP ONTO UNDIVIDED AND DIVIDED CARRIAGEWAY

DEPARTMENT OF INFRASTRUCTURE, ENERGY AND RESOURCES, TASMANIA

SIGNS AND MARKINGS

CONTRACT No. / SHEET No. / DRAWING No. / DATE

6/8/470