

DEPARTMENT *of* INFRASTRUCTURE, ENERGY *and* RESOURCES
TASMANIA
ROADWORKS SPECIFICATION
R78 – REST AREA MAINTANENCE
November 2010

| Index | | Page |
|-----------------------------------|---------------------------------------|-------------|
| R78.1 | SCOPE | 2 |
| R78.2 | REFERENCES | 2 |
| R78.3 | DEFINITIONS | 2 |
| R78.4 | REQUIREMENTS | 2 |
| R78.4.1 | General Requirements | 2 |
| R78.4.2 | Locations | 2 |
| R78.4.3 | Mowing | 2 |
| R78.4.4 | Spraying | 2 |
| R78.4.5 | Vegetation Management | 3 |
| R78.4.5 | Facilities | 3 |
| R78.4.6 | Pedestrian and Traffic Facilities | 3 |
| R78.4.7 | Drainage and Kerb Maintenance | 4 |
| R78.4.8 | Rubbish and Litter | 4 |
| R78.5 | PERFORMANCE criteria | 4 |
| R78.5.1 | Maintenance in Construction Contracts | 4 |
| R78.5.2 | Network Maintenance Contracts | 4 |
| R78.6 | PAYMENT | 4 |
| R78.6.1 | Maintenance in Construction Contracts | 4 |
| R78.6.2 | Network Maintenance Contracts | 5 |
| ANNEXURE R78A REST AREA SITE MAPS | | 6 |

DEPARTMENT of INFRASTRUCTURE, ENERGY and RESOURCES
TASMANIA
ROADWORKS SPECIFICATION
R78 – REST AREA MAINTANENCE
November 2010

R78.1 SCOPE

This Specification sets out the requirements for the maintenance of equipment, facilities and landscaping within roadside rest areas.

R78.2 REFERENCES

This Specification shall be read in conjunction with the following Specifications:

- G1 – General Provisions/MG1 Maintenance General Provisions
- G2 - Contract Management Plan/MG2 Maintenance Contract Management Plan
- G3 - Traffic Management
- R43 – Pavement and Shoulder Maintenance
- R54 – Road and Bridge Cleaning
- R59 – Sealed Pavement Maintenance
- R64 – Pavement Marking
- R65 – Road Furniture Maintenance
- R76 – Roadside Maintenance

R78.3 DEFINITIONS

None

R78.4 REQUIREMENTS

R78.4.1 General Requirements

The Contractor shall remove and dispose of all detritus and debris to a dumpsite approved and identified in accordance with Standard Specifications G1 General Provisions/MG1 Maintenance General Provisions and G2 Contract Management Plan/MG2 Maintenance Contract Management Plan.

R78.4.2 Locations

Rest Areas to which this Specification applies are at the locations In *Table R78.1 Rest Area Locations*.

Table 1 R78.1 Rest Area Locations

| Rest Area | Road No | Road Name | Link | Ch. |
|-----------------------|---------|---------------|------|-------|
| Batman Bridge Reserve | A0278 | Batman Hwy | 05 | 5.72 |
| Tullochgorum | A1125 | Esk MR | 57 | 5.20 |
| Conara | A0087 | Midland Hwy | 74 | 1.06 |
| Paramatta Creek | A0249 | Bass Hwy | 02 | 0.10 |
| Hellyer Gorge | A0485 | Murchison Hwy | 69 | 10.53 |
| Fossey River | A0485 | Murchison Hwy | 52 | 6.57 |
| St Peters Pass | A0087 | Midland Hwy | 43 | 10.28 |

For site plans refer to Annexure R78A Rest Area Site Maps.

R78.4.3 Mowing

Rest areas shall be mowed to Type A standards.

All mowing shall be performed in accordance with *Standard Specification R76 Roadside Maintenance* or as instructed by the Superintendent.

R78.4.4 Spraying

All herbicide spraying shall be performed in accordance with *Standard Specification R76 Roadside Maintenance* in particular Clause R76.4.6 or as instructed by the Superintendent.

DEPARTMENT of INFRASTRUCTURE, ENERGY and RESOURCES
TASMANIA
ROADWORKS SPECIFICATION
R78 – REST AREA MAINTANENCE
November 2010

R78.4.5 Vegetation Management

The contractor shall, at six (6) monthly intervals:

- collect and dispose of all dead limbs on vehicle access ways and walking tracks,
- maintain a 5.6m clear height portal under all trees along access roads and service tracks and
- thoroughly inspect the rest area site and report any dead trees and dead limbs on trees.

R78.4.5 Facilities

The toilet and washroom facilities at each Rest Area shall be cleaned and disinfected, all litter and sanitary bins emptied and all consumables including toilet paper, light bulbs and soap shall be replaced as necessary.

All barbeque, shelters and picnic areas shall be cleaned and maintained so that the facilities can perform their intended function.

Inspect all septic tanks and ensure they are pumped out at the required frequencies and the contents disposed at a suitable licensed treatment plant.

The treatment plants shall be inspected and maintained in a working order in accordance with their operations and maintenance manuals. Note any unusual noises or apparent drops in performance of mechanical equipment.

Any form of leaks from the treatment plant or associated pipe work shall be notified to the Superintendent immediately

Undertake sampling of the effluent discharged from any treatment plant and arrange testing at a NATA registered laboratory for the following parameters and at the stated frequencies listed in **Table R78.2 Effluent Discharge Sampling Frequencies**.

Table R78.2 Effluent Discharge Sampling Frequencies

| PARAMETER | FREQUENCY |
|-------------------------------------|---------------------|
| Flow | Weekly |
| BOD* (mg/l) | Monthly / quarterly |
| Non-Filterable Residue (mg/l) | Monthly / quarterly |
| Thermotolerant Coliforms(cfu/100ml) | At least monthly |
| Oil and Grease (mg/l) | Monthly / quarterly |
| Total Nitrogen (mg/l) | Monthly / quarterly |
| Ammonia - Nitrogen (mg/l) | At least quarterly |
| Total Phosphorus (mg/l) | At least quarterly |
| pH | Weekly |

R78.4.6 Pedestrian and Traffic Facilities

All sealed pedestrian and traffic surfaces shall be maintained in accordance with *Standard Specification R54 Road and Bridge Cleaning* and *Standard Specification R59 Sealed Pavement Maintenance*.

All unsealed pedestrian and traffic surfaces shall be maintained in accordance with *Standard Specification R43 Pavement and Shoulder Maintenance*.

All road furniture shall be maintained in accordance with *Standard Specification R65 Road Furniture Maintenance*.

DEPARTMENT of INFRASTRUCTURE, ENERGY and RESOURCES
TASMANIA
ROADWORKS SPECIFICATION
R78 – REST AREA MAINTANENCE
November 2010

R78.4.7 Drainage and Kerb Maintenance

All drainage facilities and kerbing shall be maintained in accordance with *Standard Specification R34 Drainage and Kerb Maintenance*.

R78.4.8 Rubbish and Litter

All rubbish and litter shall be collected from around the site and in rubbish bins and disposed of in accordance with *Standard Specification R76 Roadside Maintenance*.

All dead animals within the rest area, or within close proximity that are causing an odour nuisance, shall be collected and disposed off site at a dumpsite approved and identified in accordance with Standard Specifications G1 General Provisions/MG1 Maintenance General Provisions and G2 Contract Management Plan/MG2 Maintenance Contract Management Plan.

R78.5 PERFORMANCE CRITERIA

R78.5.1 Maintenance in Construction Contracts

The Intervention Level, the condition following treatment or reinstatement, Inspection Frequency and Response Times, are set out in **Table R78.3 Intervention Levels Construction Contracts**.

Table R78.3 Intervention Levels Construction Contracts

| ROUTINE MAINTENANCE TREATMENT | INTERVENTION LEVEL | MINIMUM CONDITION AFTER TREATMENT |
|---|------------------------------|---|
| Roadside verges | As per R76 | As per R76 |
| Sealed Surfaces | As per R59 | As per R59 |
| Unsealed Surfaces and shoulders | As per R43 | As per R43 |
| Drainage and Kerbs | As per R34 | As per R34 |
| Toilet Facilities Barbeque and Picnic Facilities | As specified in the Contract | Toilet facilities clean. Toilet disposal facilities functioning correctly. Consumables replenished. Lighting functional A litter and debris cleared. Barbeque and picnic facilities clean and functional |

R78.5.2 Network Maintenance Contracts

The Performance Standards will be in accordance with the specified performance standards in the Contract.

R78.6 PAYMENT

R78.6.1 Maintenance in Construction Contracts

Payment shall be the relevant Scheduled Rate and shall include the supply of all plant, labour, materials and disposal of waste materials.

Payment for the maintenance management of rest areas shall include: roadside verges, sealed surfaces, unsealed surfaces and shoulders, drainage and kerbs, toilet facilities, barbeque and

picnic areas. Payment shall be pro-rata basis over the contract period (ref schedule of rates 8.07).

R78.6.2 Network Maintenance Contracts

Payment shall be in accordance with the relevant clauses and attachments in the Basis of Payment section of the Contract.

DEPARTMENT *of* INFRASTRUCTURE, ENERGY *and* RESOURCES
TASMANIA
ROADWORKS SPECIFICATION
R78 – REST AREA MAINTANENCE
November 2010

ANNEXURE R78A REST AREA SITE MAPS

DEPARTMENT of INFRASTRUCTURE, ENERGY and RESOURCES
 TASMANIA
 ROADWORKS SPECIFICATION
 R78 – REST AREA MAINTENANCE
 November 2010

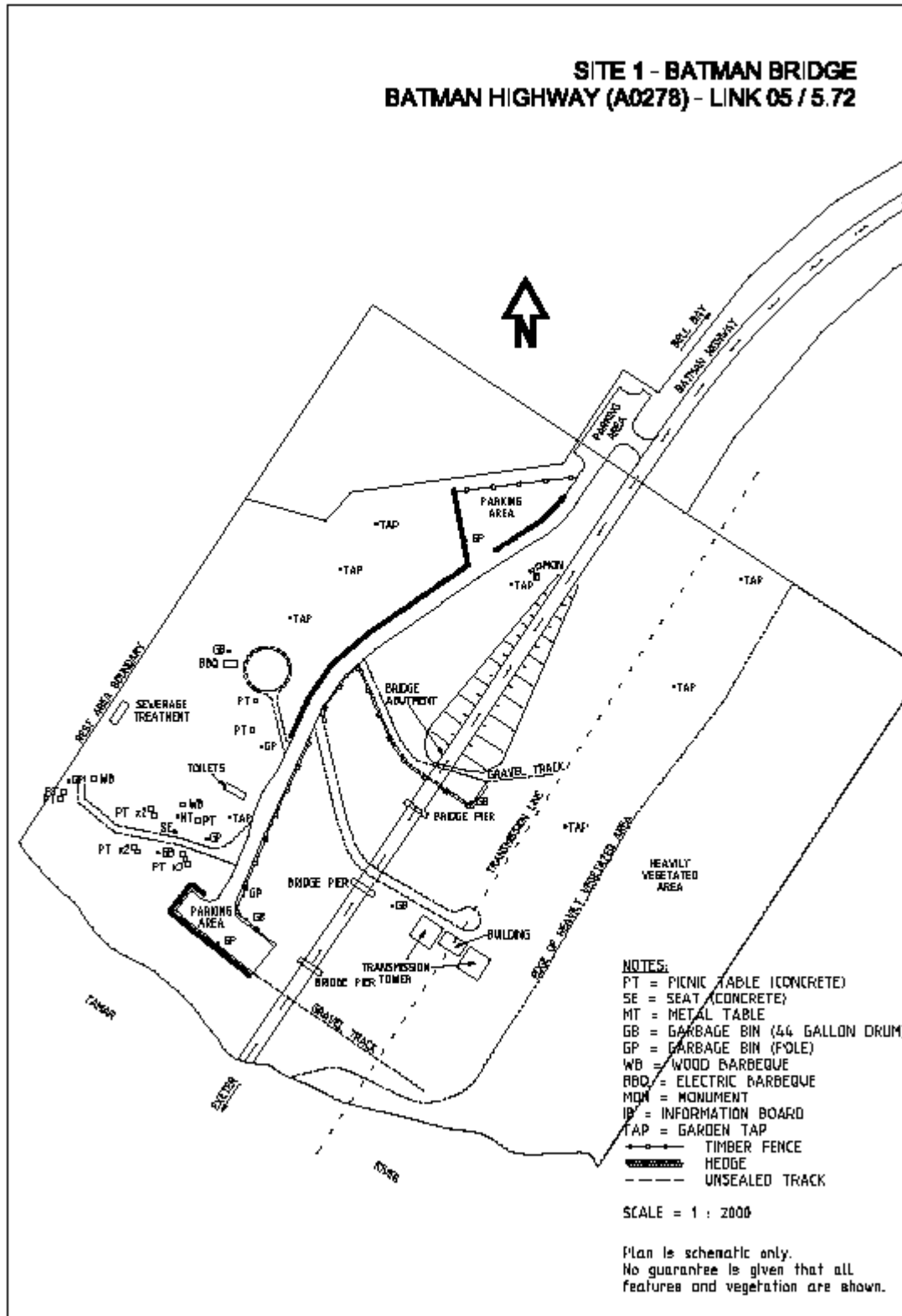

DEPARTMENT of INFRASTRUCTURE, ENERGY and RESOURCES
TASMANIA
ROADWORKS SPECIFICATION
R78 – REST AREA MAINTANENCE
November 2010

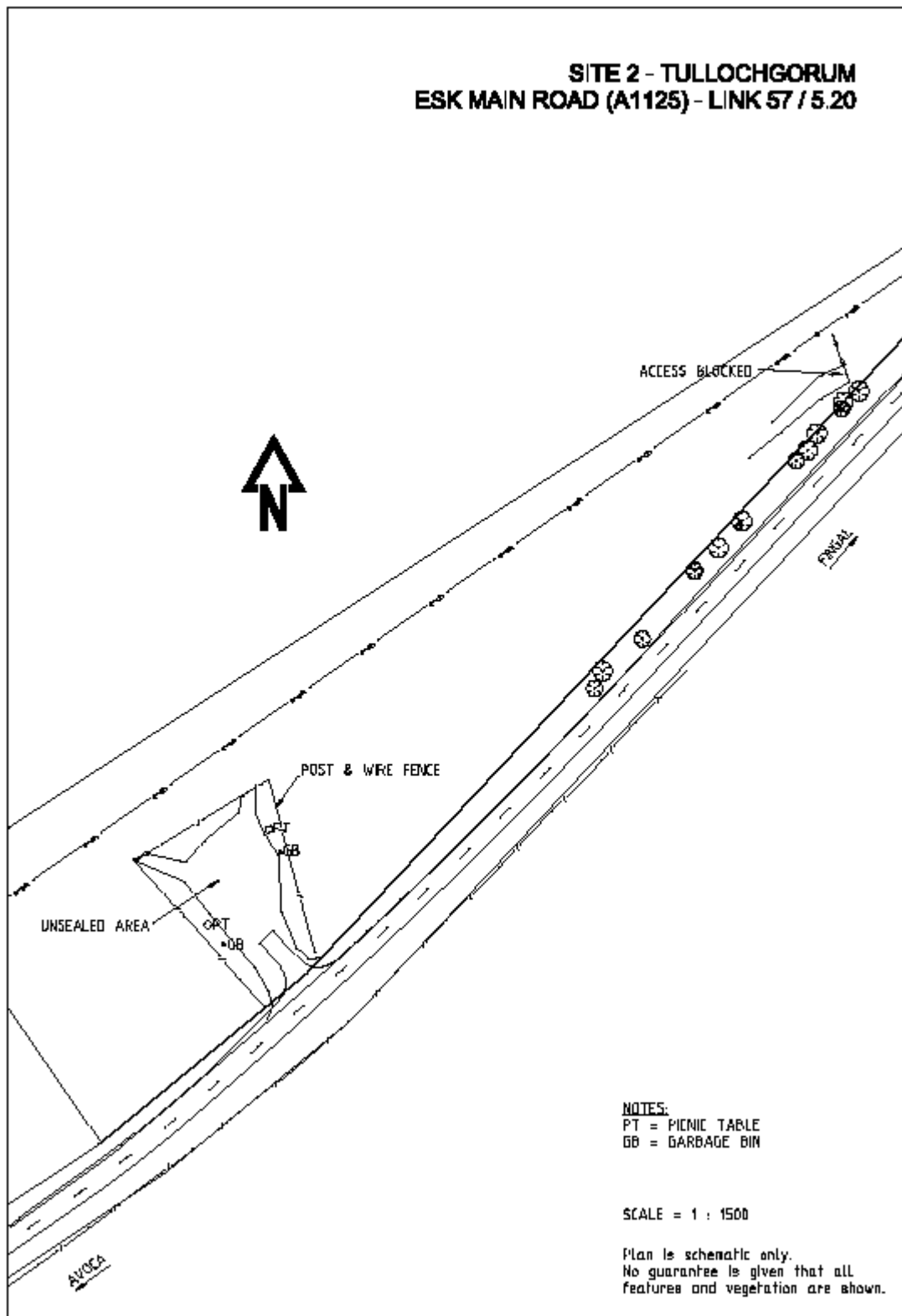

DEPARTMENT of INFRASTRUCTURE, ENERGY and RESOURCES
TASMANIA
ROADWORKS SPECIFICATION
R78 – REST AREA MAINTENANCE
November 2010

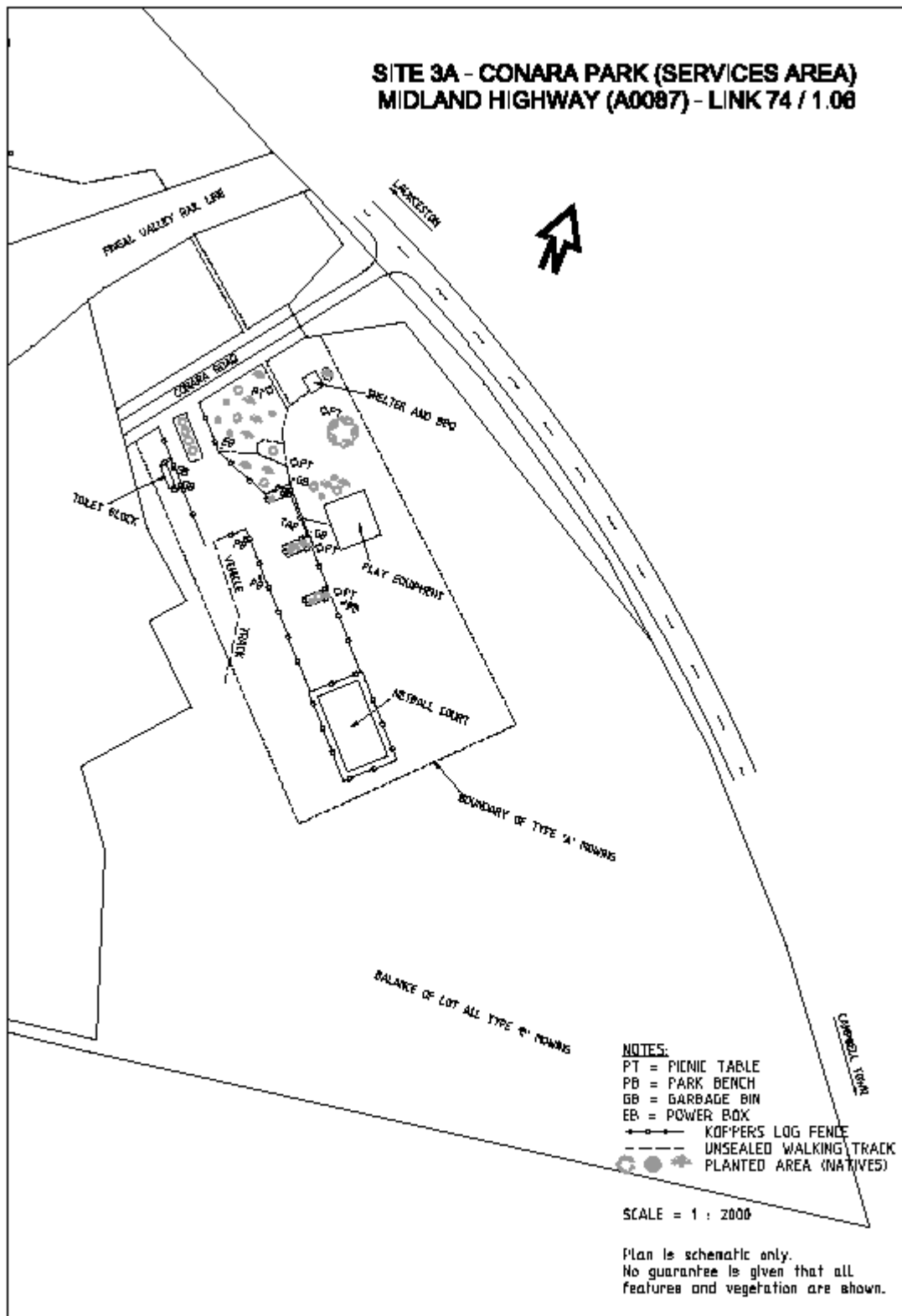

DEPARTMENT of INFRASTRUCTURE, ENERGY and RESOURCES
TASMANIA
ROADWORKS SPECIFICATION
R78 – REST AREA MAINTANENCE
November 2010

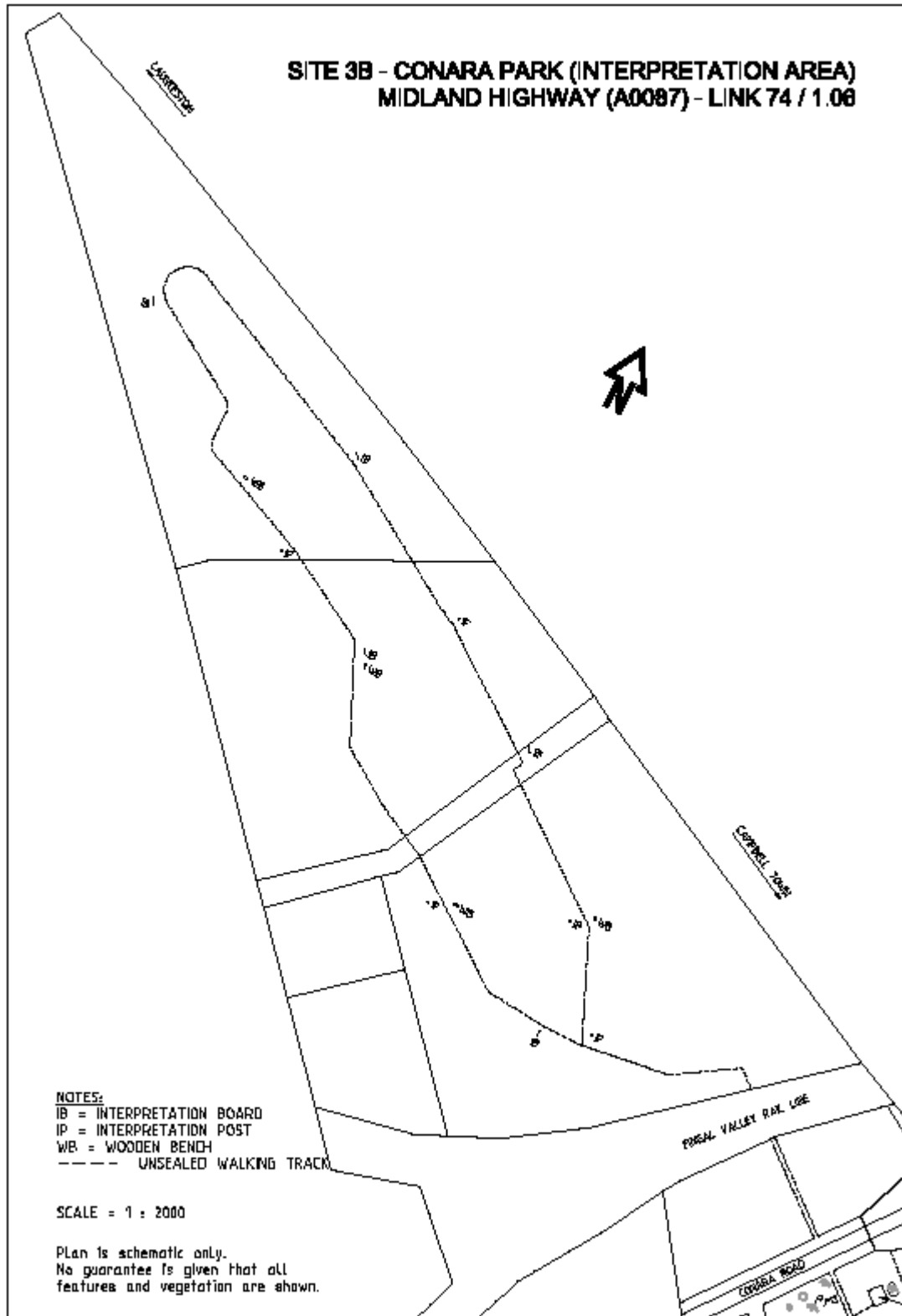

DEPARTMENT of INFRASTRUCTURE, ENERGY and RESOURCES
TASMANIA
ROADWORKS SPECIFICATION
R78 – REST AREA MAINTENANCE
November 2010

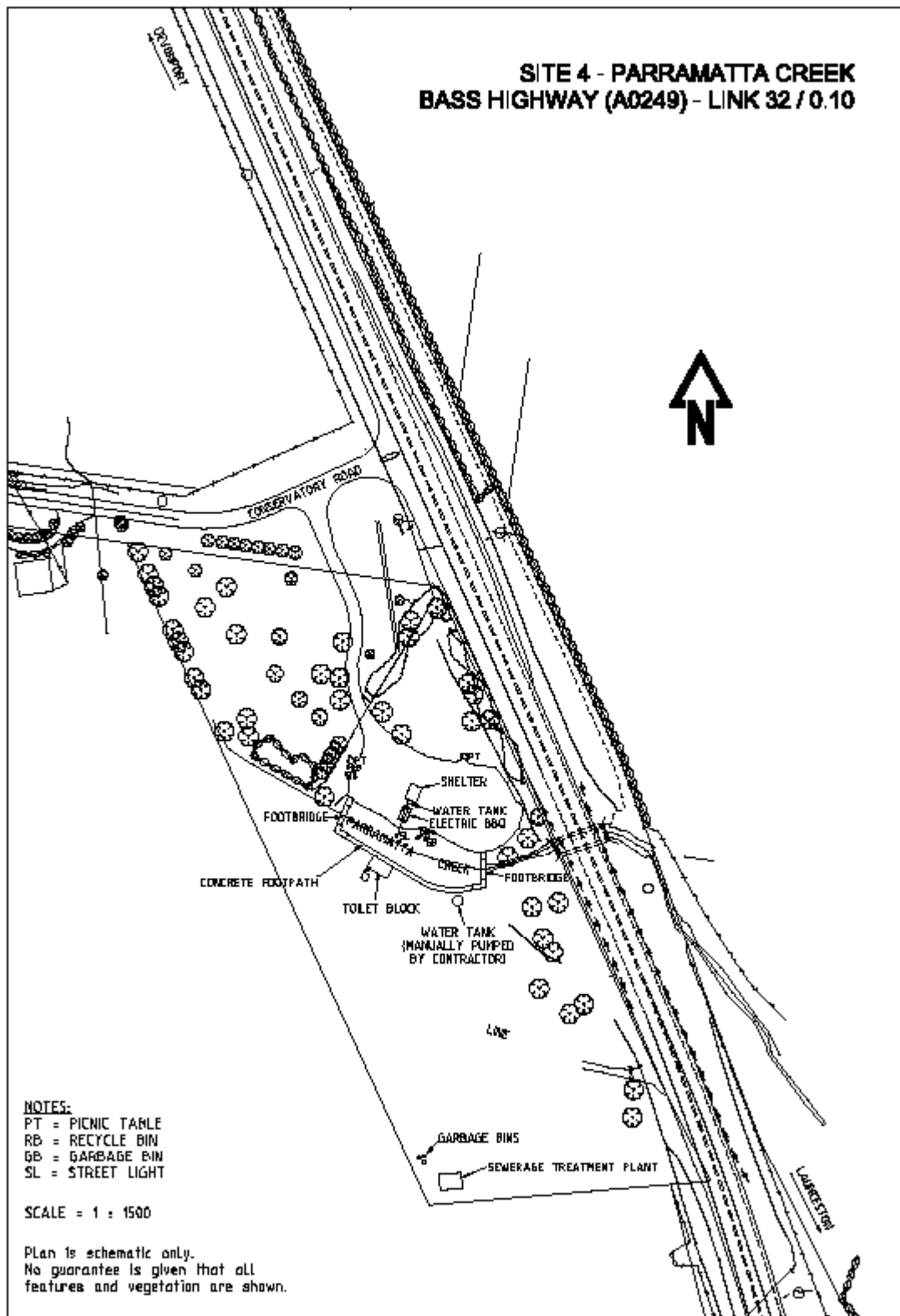

DEPARTMENT of INFRASTRUCTURE, ENERGY and RESOURCES
TASMANIA
ROADWORKS SPECIFICATION
R78 – REST AREA MAINTANENCE
November 2010

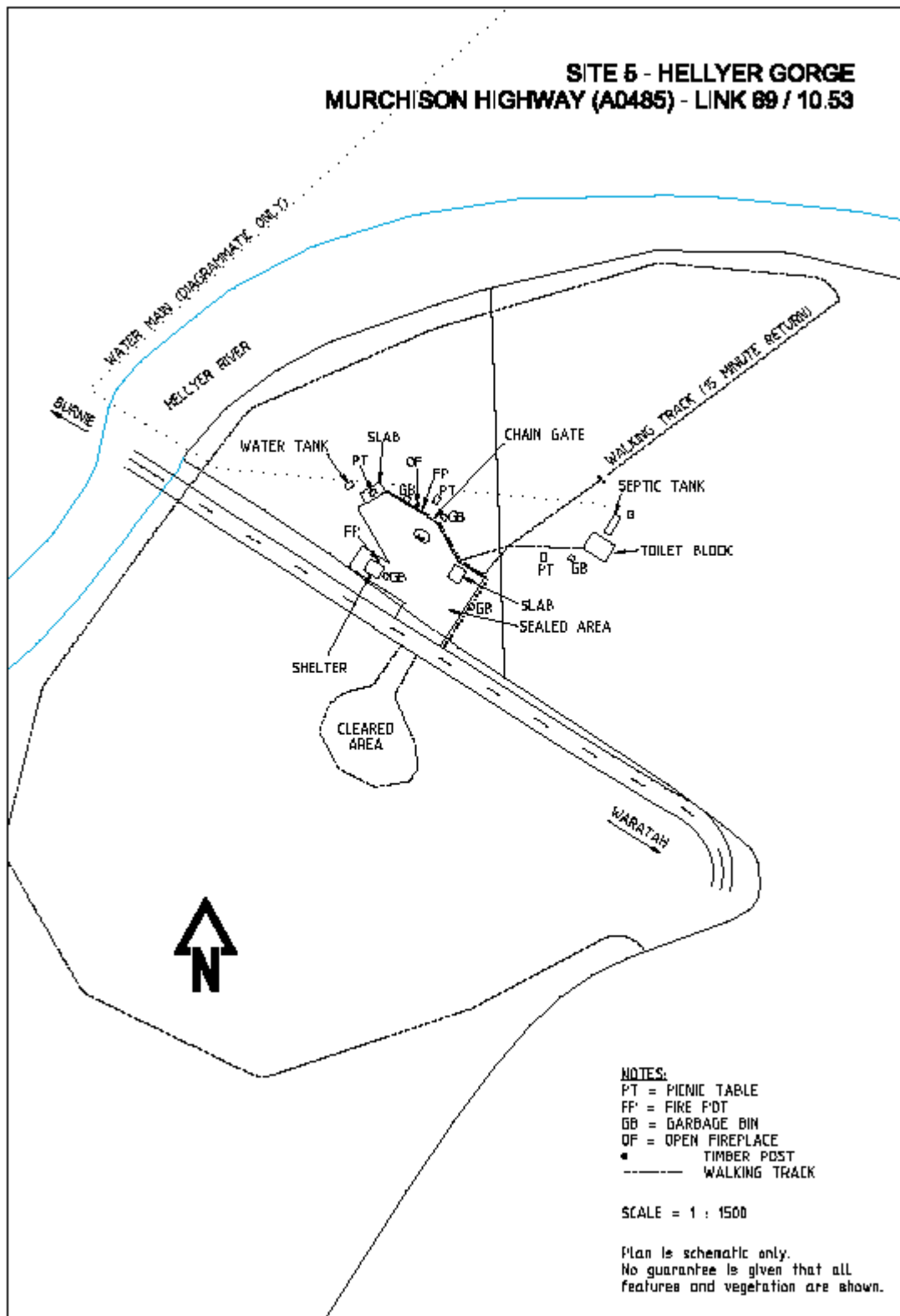

DEPARTMENT of INFRASTRUCTURE, ENERGY and RESOURCES
 TASMANIA
 ROADWORKS SPECIFICATION
 R78 – REST AREA MAINTENANCE
 November 2010

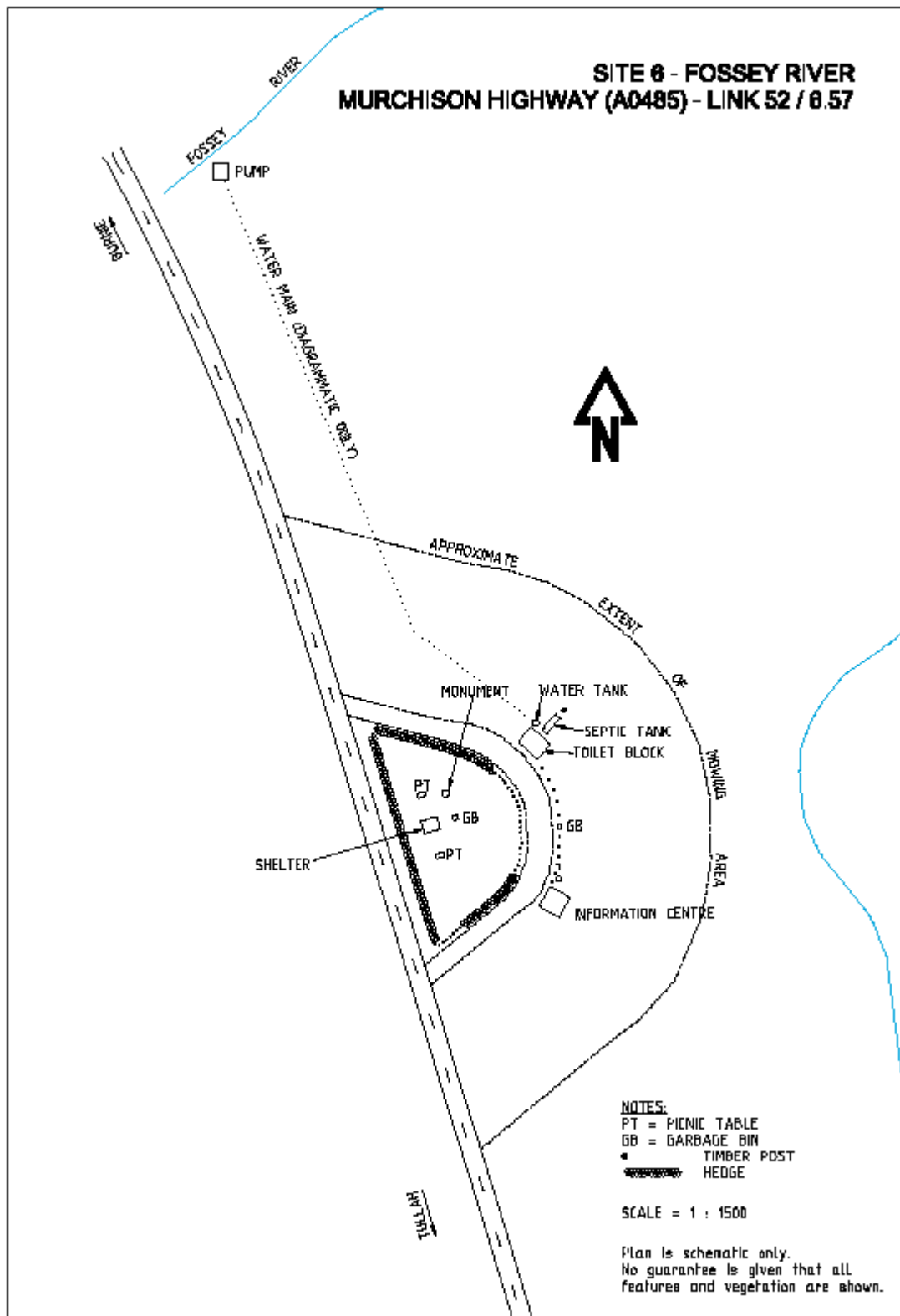

DEPARTMENT of INFRASTRUCTURE, ENERGY and RESOURCES
TASMANIA
ROADWORKS SPECIFICATION
R78 – REST AREA MAINTANENCE
November 2010

